

Apply the De Ryck Stone strips professionally

DE RYCK

true to nature



- For application on special surfaces or onto wall-front insulation, consult with Weser's technical service.
- Work at a temperature of 10 to 25 degrees.
- Use the appropriate De Ryck adhesives and installation products.

Always keep the products dry!



The surface must be consistent, flat and clean. It must be dry and free of grease. If the surface is porous then apply first a layer of Cemix Primer. Allow to dry for 2 hours and then you can begin.

Section off the wall in areas for about five brick strips. Allow 1 cm for the joint. Within these sections you can work by sight.

Apply the adhesive in sections of $\frac{1}{2}$ m² so it doesn't dry before you fix the brick strips. Stains from spotting and spilling can then still be easily removed.



Start by making ribs in the glue with a notched spatula (6 mm for InterFIX, 8 mm for Granulit and 10 mm for Murok).

Then apply the brick strip in a sliding motion. Always start with the corners and mix strips from different boxes.

For the heavier stone products of the Murok range the installation with the buttering-float technique is obligated.

This means that the glue must be applied as well on the back of the slips as on the wall-surface.

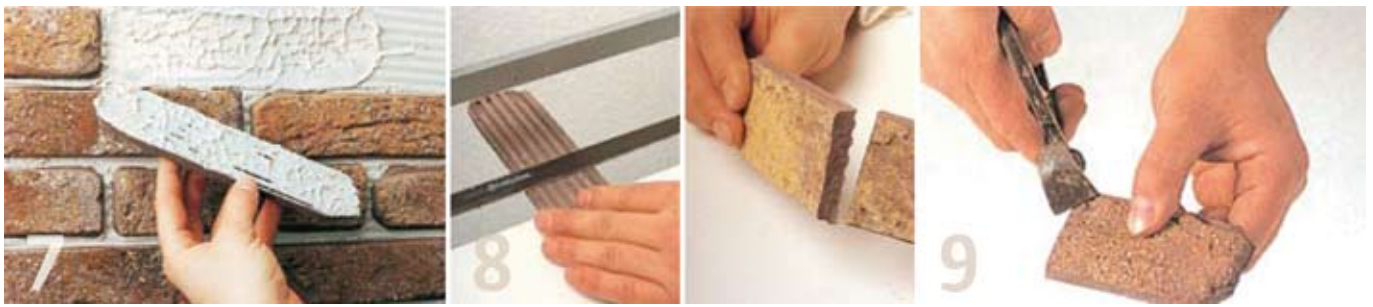

In this way you can monitor if the strips are well attached to the wall.

To size the strips as needed, saw them or notch them in the back and then break along the line.

Place cut pieces together in a way to preserve the rustic character.



Filling joints is done with Cemix Unijoint which is mixed with water. In the right proportion, the mix is still a bit rough, sticky and on the dry side. Keep using the same proportion of water to avoid colour variations.

Apply the joint-filling mortar with a traditional pointing trowel and sweep clear with one stroke. The vertical joints are usually a bit smaller than the horizontal joints.

Clean away the extra mortar with a stiff dry brush before it has completely dried.



InterFIX joints can be filled in the traditional manner. Or the InterFIX glue can be stroked smooth in the joint. Do this with a damp finishing brush, such that the glue seals with the edge of the strip.

Outside walls should always be sealed with Silifin. The wall must be completely dry before you apply the Silifin with a brush until thoroughly covered.

The enclosed information is based on our experience and knowledge up to date. Different wall surfaces and other circumstances could affect the installation.

Therefore the installer shall apply the products professionally and execute previous tests on the proposed wall surface. It is the reseller's responsibility to forward all technical information we provide.